

# QUANTUM GW8

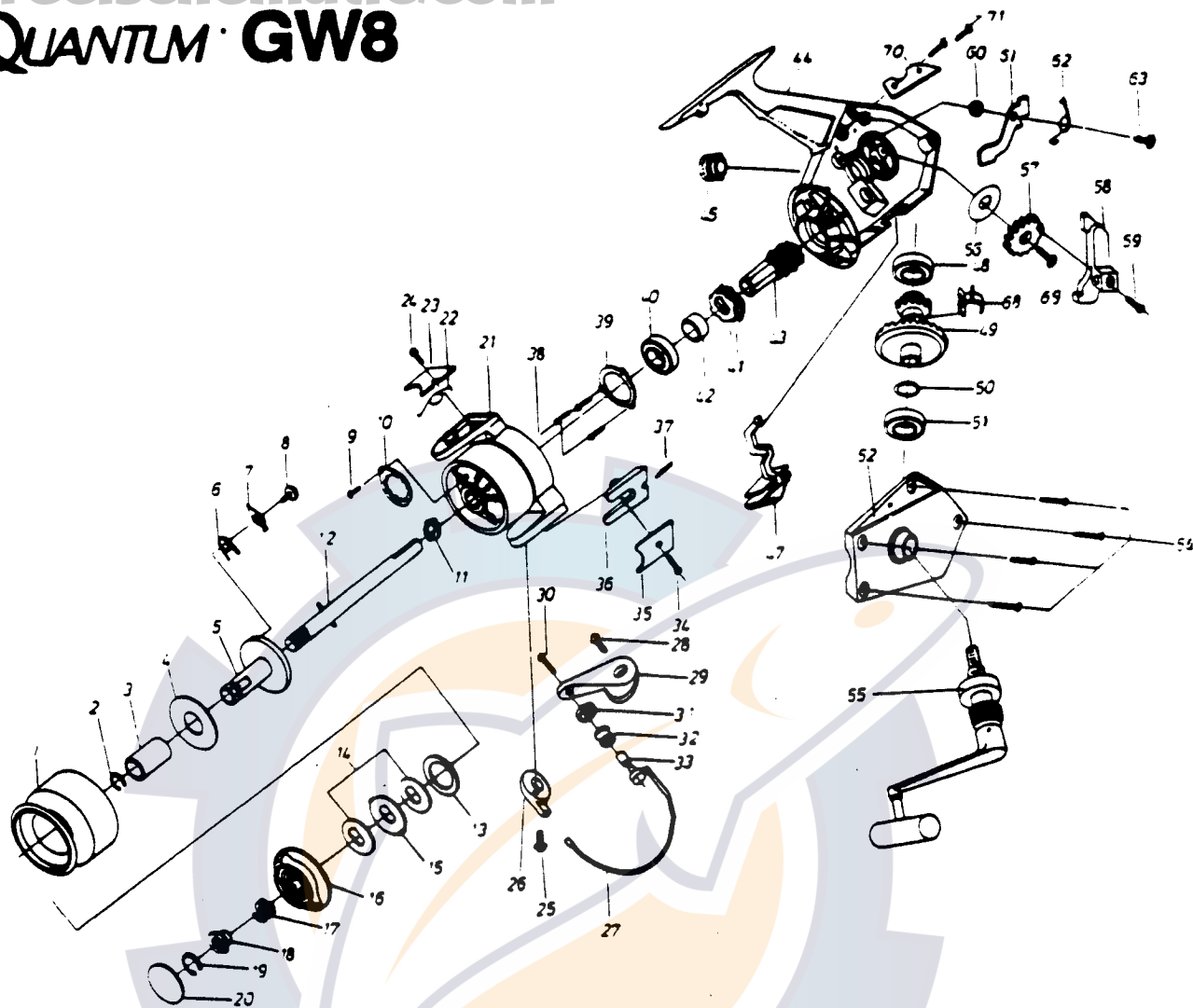

KEY PART NO. NO.	DESCRIPTION	PRICE	KEY PART NO. NO.	DESCRIPTION	PRICE
1 FL321	SPOOL ASSY. (1-8,13-15)	14.46	41 YK060	STOPPER GEAR	2.68
4 YK163	SPOOL RETAINER BUSHING	3.21	42 YK126	PINION COLLAR	1.39
9 YK058	NUT RING SCREW	.88	43 FLO11	PINION	10.30
10 WK086	ROTOR NUT RING	1.07	44 FLO01	BODY	10.56
11 YK006	ROTOR NUT	1.44	45 YK073	DUST COVER	1.93
12 YK315	CENTER SHAFT	7.43	47 YK039	ANTI-REVERSE SWITCH	.91
13 WK046	DRAG WASHER 'C'	1.39	48 FL157	BODY/SIDE PLATE BEARING	8.55
14 WK039	DRAG WASHER 'B'	1.93	49 FLO12	CRANK GEAR	1.45
16 FLO90	DRAG KNOB ASSY. (16-20)	9.46	50 WK026	CRANK GEAR WASHER	.91
21 FLO09	ROTOR	8.50	51 FL157	BODY/SIDE PLATE BEARING	8.55
22 YK022	ARM LEVER SPRING	.91	52 FLO23	SIDE PLATE	1.49
23 YK087	ARM LEVER COVER	1.39	54 WK057	SIDE PLATE SCREW	2.14
24 UK089	ARM LEVER COVER SCREW	1.34	55 FL318	HANDLE ASSY.	10.30
25 YK048	BAIL HOLDER SCREW	1.39	56 YK165	OSC. GUIDE WASHER	1.29
26 YK349	BAIL HOLDER	3.38	57 YK053	OSCILLATOR GEAR	1.44
27 YK346	BAIL WIRE	3.89	58 YK029	OSCILLATOR GUIDE	1.44
28 YK051	ARM LEVER SCREW	1.61	59 WK084	CENTER SHAFT SCREW	.75
29 YK007	ARM LEVER	1.34	60 WK014	STOPPER SUPPORT BUSHING	.91
30 YK108	LINE SLIDER SCREW	1.44	61 YK063	STOPPER	1.87
31 YK017	LINE SLIDER COLLAR	1.44	62 YK061	STOPPER SPRING	1.87
32 YK004	LINE ROLLER	2.19	63 YK089	STOPPER SCREW	1.44
33 YK016	LINE ROLLER BUSHING	1.93	64 YK166	STOPPER SUPPORT	1.93
34 UK037	BAIL HOLDER COVER SCREW	.75	68 WK086	SLIDING SPRING	.75
35 YK024	BAIL HOLDER COVER	1.39	69 YK078	OSC. GEAR SCREW	1.44
36 YK019	KICK LEVER	1.93	70 YK167	OSC. GUIDE SUPPORT	1.87
37 YK049	KICK LEVER SPRING	.97	71 UK168	OSC. SUPPORT SCREW	.75
38 UK080	BEARING COVER SCREW	1.07	72 YK065	ROTOR RETAINER WASHER	.88
39 YK040	BEARING COVER	2.09			
40 YK028	PINION BEARING	10.12			

Prices subject to change without notice. Prices do not include postage and handling.

**PLEASE ORDER BY PART NUMBER**

Rev. 11/90

Zebco Division Brunswick Corporation, Box 270, Tulsa, OK 74101 USA 918-636-6881



BRUNSWICK